

HORACE MANN ELEMENTARY SCHOOL

COMMUNITY UPDATE

June 25, 2025 6:00PM



City of Newton
Ruthanne Fuller, Mayor



NEWTON
PUBLIC SCHOOLS



RAYMOND DESIGN
ASSOCIATES
ARCHITECTURE & PLANNING



AGENDA

1 SITE LOGISTICS

2 PROGRESS PHOTOS

3 CONTACTS



HORACE MANN ELEMENTARY SCHOOL
COMMUNITY UPDATE



RAYMOND DESIGN
ASSOCIATES
ARCHITECTURE & PLANNING



HORACE MANN ELEMENTARY SCHOOL COMMUNITY UPDATE

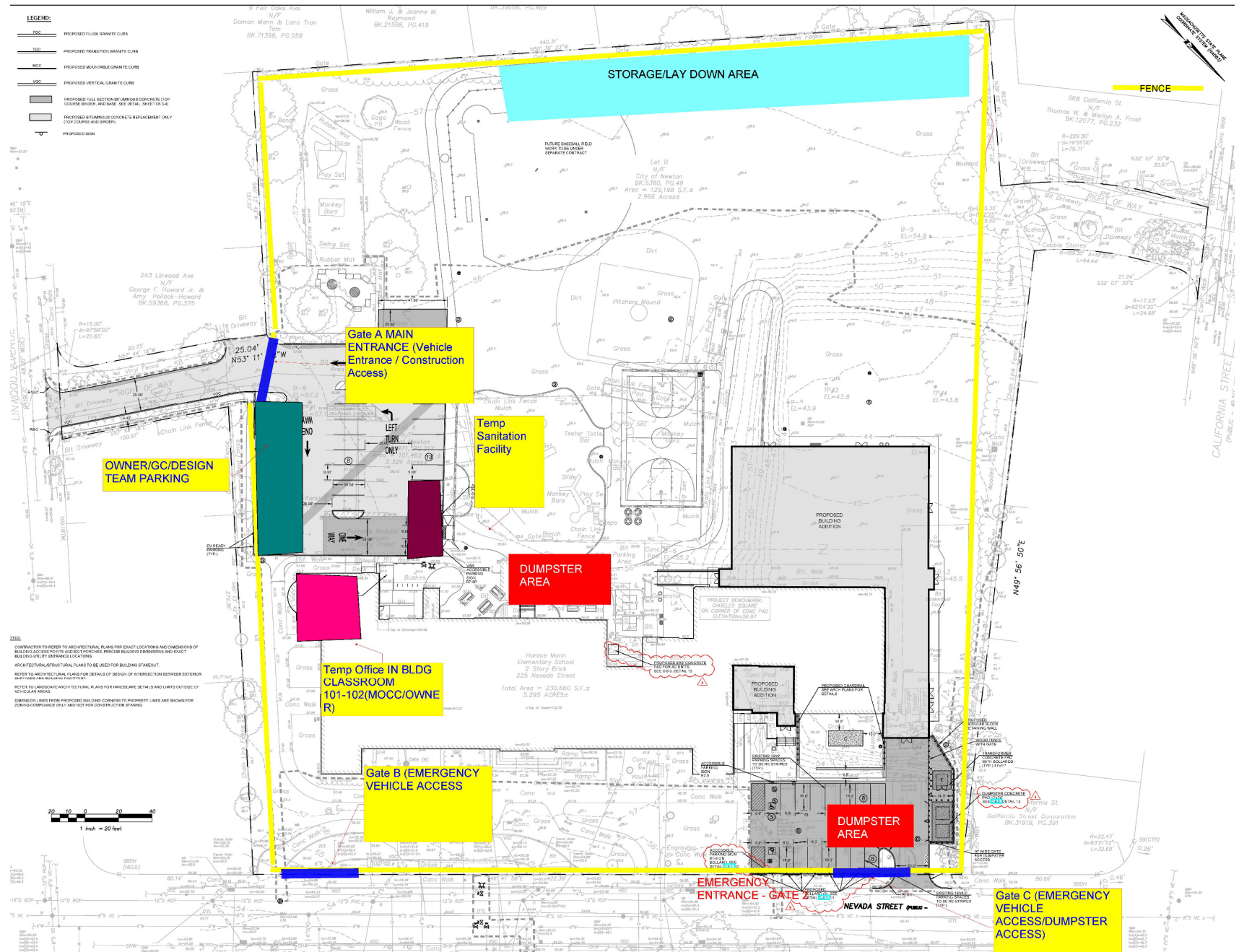

SCHEDULE UPDATE

Foundations

Summer 2025

Steel Superstructure

Fall 2025

Weathertight

Fall - Winter 2025

Envelope

Fall 2025 – Spring 2026

Trade Rough-in

Winter 2025 - 2026

Interior Drywall

Winter – Spring 2026

Interior Finishes

Spring – Summer 2026

Substantial Completion

Summer 2026

**HORACE MANN ELEMENTARY SCHOOL
COMMUNITY UPDATE**



RAYMOND DESIGN
ASSOCIATES
ARCHITECTURE & PLANNING



PHOTOGRAPHS



Close-up of ground improvements under way

Ground Improvements in area of new building



Excavation preparation



Formwork in place



RAYMOND DESIGN
ASSOCIATES
ARCHITECTURE & PLANNING



Q & A

Project Information



www.horacemann.projects.nv5.com



www.facebook.com/BuildingsNewtonMA/



www.instagram.com/newtonmapbd/

Further Information

Tom Rooney, City of Newton Project Manager

trooney@newtonma.gov

Tom Murphy, NV5 Project Director

thomas.murphy@nv5.com

**HORACE MANN ELEMENTARY SCHOOL
COMMUNITY UPDATE**



NV5



**RAYMOND DESIGN
ASSOCIATES**
ARCHITECTURE & PLANNING

MOCC
M. O'CONNOR CONTRACTING, INC.